



**TÉCNICO
LISBOA**



ORDEM
DOS
ENGENHEIROS

**4th International Conference on Maritime Technology
and Engineering**

MARTECH 2018 PROGRAMME

7 - 9 May 2018

IST Congress Centre
LISBON, PORTUGAL



ORGANISATION

Conference Chairmen

Carlos Guedes Soares, IST, Universidade de Lisboa, Portugal
Pedro Ponte, Ordem dos Engenheiros, Portugal

Organizing Committee

Tiago A. Santos, Ordem dos Engenheiros, Portugal
Yordan Garbatov, IST, Universidade de Lisboa, Portugal
Dina Dimas, Ordem dos Engenheiros, Portugal
Ângelo Teixeira, IST, Universidade de Lisboa, Portugal
António Oliveira, Transinsular, Portugal
Manuel Ventura, IST, Universidade de Lisboa, Portugal
Paulo Viana, Ordem dos Engenheiros, Portugal
Paulo Pires Silva, Escola Naval, Portugal
Abel Simões, ENIDH, Portugal

Technical Programme Committee

Ermina Begovic, Italy
Kostas Belibassakis, Greece
Rui Carlos Botter, Brazil
Evangelos Boulougouris, UK
Dario Bruzzone, Italy
Nian Zhong Chen, UK
Matthew Collette, USA
Giorgio Contento, Italy
Vicente Díaz Casás, Spain
Leonard Domnisoru, Romania
Soren Ehlers, Germany
Selma Ergin, Turkey
Segen F. Estefen, Brasil
Pierre Ferrant, France
Juana Fortes, Portugal
Yordan Garbatov, Portugal
Sérgio Garcia, Spain
Peter Georgiev, Bulgaria
Hercules Haralambides, Netherlands
Chunyan Ji, China
Xiaoli Jiang, Netherlands
Jean-Marc Laurens, France

Luis Ramon Nuñez, Spain
Marcelo Ramos Martins, Brazil
Ould El Moctar, Germany
Thanos Pallis, Greece
Apostolos Papanikolaou, Greece
Josko Parunov, Croatia
Preben T Pedersen, Denmark
Jasna Prpić-Oršić, Croatia
Harilaos Psaraftis, Denmark
Jonas Ringsberg, Sweden
Germán R. Rodríguez, Spain
Jani Romanoff, Finland
Xin Shi, China
Asgeir Johan Sørensen, Norway
Maciej Taczala, Poland
Michele Viviani, Italy
Alex Vredeveldt, Netherlands
Decheng Wan, China
Duan Wenyang, China
Xinping Yan, China
Peilin Zhou, UK
Ling Zhu, China

Technical Programme & Conference Secretariat

Sandra Ponce, IST, Universidade de Lisboa, Portugal
Maria de Fátima Pina, IST, Universidade de Lisboa, Portugal
Sónia Vicente, IST, Universidade de Lisboa, Portugal
Bárbara Azevedo, IST, Universidade de Lisboa, Portugal
Bruna Covelas, IST, Universidade de Lisboa, Portugal

Sessions in alphabetical order

Monday, 7th May 2018

Dynamics & Control - Room 01.1, Monday, 7th May 2018 (14h00-15h30)
Opening Session – Auditorium, Monday, 7th May 2018 (10h00-10h30)
Plenary Session (Keynote lectures) – Auditorium, Monday, 7th May 2018 (10h30-12h30)
Ship Design - Room 02.3, Monday, 7th May 2018 (14h00-15h30)
Ship Performance - Room 01.1, Monday, 7th May 2018 (16h00-17h30)
Structures in Composite Materials - Room 02.3, Monday, 7th May 2018 (16h00-17h30)

Tuesday, 8th May 2018

Computational Fluid Dynamics - Room 02.1, Tuesday, 8th May 2018 (14h00-15h30)
Offshore and Subsea Technology - Room 02.3, Tuesday, 8th May 2018 (16h00-17h30)
Port Performance I - Room 01.1, Tuesday, 8th May 2018 (9h00 – 10h30)
Port Performance II - Room 01.1, Tuesday, 8th May 2018 (11h00-12h30)
Risk Analysis - Room 02.3, Tuesday, 8th May 2018 (14h00-15h30)
Ship Motions I - Room 02.1, Tuesday, 8th May 2018 (9h00 – 10h30)
Ship Motions II - Room 02.1, Tuesday, 8th May 2018(11h00-12h30)
Ship Resistance - Room 02.1, Tuesday, 8th May 2018 (16h00-17h30)
Ship Structures I - Room 01.1, Tuesday, 8th May 2018 (14h00-15h30)
Ship Structures II - Room 01.1, Tuesday, 8th May 2018 (16h00-17h30)
Wave and Wind Energy - Room 02.3, Tuesday, 8th May 2018 (11h00-12h30)
Wave-structure interaction - Room 02.3, Tuesday, 8th May 2018 (09h00 – 10h30)

Wednesday, 9th May 2018

Big Data in Shipping - Room 01.1, Wednesday, 9th May 2018 (14h00-15h30)
Coating & Corrosion - Room 01.1, Wednesday, 9th May 2018 (9h00 – 10h00)
Intelligent Ship Navigation - Room 01.1, Wednesday, 9th May 2018 (16h00-17h30)
Maintenance - Room 02.1, Wednesday, 9th May 2018 (9h00 – 10h00)
Marine Pollution & Sustainability - Room 02.1, Wednesday, 9th May 2018 (14h00-15h30)
Maritime Transportation and Economics - Room 01.1, Wednesday, 9th May 2018 (10h30-12h30)
Ship Propulsion - Room 02.1, Wednesday, 9th May 2018 (16h00-17h30)
Ships in Transit - Room 02.3, Wednesday, 9th May 2018 (9h00 – 10h00)
Shipyard Technology - Room 02.1, Wednesday, 9th May 2018 (10h30-12h30)
Waves - Room 02.3, Wednesday, 9th May 2018 (10h30-12h30)

SCHEDULE AT A GLANCE

MARTECH2018

Monday, 7th May 2018 Registration (Hall 01 – from 8h30 onwards)		
IST Congress Centre		
Opening Session (10h00-10h30) – Auditorium Chaired by the Portuguese Minister of the Sea, Ana Paula Vitorino		
Plenary Session (10h30-12h30) – Auditorium Keynote lectures Co-Chairs: C. Guedes Soares & P. Ponte		
<i>Lunch</i> (12h30-14h00)		
<i>Room 01.1</i> (14h00-15h30) Dynamics & Control	<i>Room 02.3</i> (14h00-15h30) Ship Design	
<i>Coffee-break</i> (15h30-16h00)		
<i>Room 01.1</i> (16h00-17h30) Ship Performance	<i>Room 02.3</i> (16h00-17h30) Structures in Composite Materials	
Tuesday, 8th May 2018 Registration (Hall 01 – from 8h30 onwards)		
<i>Room 01.1</i> (9h00 – 10h30) Port Performance I	<i>Room 02.1</i> (9h00 – 10h30) Ship Motions I	<i>Room 02.3</i> (09h00 – 10h30) Wave-structure interaction
<i>Coffee-break</i> (10h30-11h00)		

<i>Room 01.1 (11h00-12h30)</i> Port Performance II	<i>Room 02.1 (11h00-12h30)</i> Ship Motions II	<i>Room 02.3 (11h00-12h30)</i> Wave and Wind Energy
<i>Lunch (12h30-14h00)</i>		
<i>Room 01.1 (14h00-15h30)</i> Ship Structures I	<i>Room 02.1 (14h00-15h30)</i> Computational Fluid Dynamics	<i>Room 02.3 (14h00-15h30)</i> Risk Analysis
<i>Coffee-break (15h30-16h00)</i>		
<i>Room 01.1 (16h00-17h30)</i> Ship Structures II	<i>Room 02.1 (16h00-17h30)</i> Ship Resistance	<i>Room 02.3 (16h00-17h30)</i> Offshore and Subsea Technology
20:00 h - Conference Dinner		
Wednesday, 9th May 2018 Registration (Hall 01 – from 8h30 onwards)		
<i>Room 01.1 (9h00 – 10h00)</i> Coating & Corrosion	<i>Room 02.1 (9h00 – 10h00)</i> Maintenance	<i>Room 02.3 (9h00 – 10h00)</i> Ships in Transit
<i>Coffee-break (10h00-10h30)</i>		
<i>Room 01.1 (10h30-12h30)</i> Maritime Transportation and Economics	<i>Room 02.1 (10h30-12h30)</i> Shipyards Technology	<i>Room 02.3 (10h30-12h30)</i> Waves
<i>Lunch (12h30-14h00)</i>		
<i>Room 01.1 (14h00-15h30)</i> Big Data in Shipping	<i>Room 02.1 (14h00-15h30)</i> Marine Pollution & Sustainability	
<i>Coffee-break (15h30-16h00)</i>		
<i>Room 01.1 (16h00-17h30)</i> Intelligent Ship Navigation	<i>Room 02.1 (16h00-17h30)</i> Ship Propulsion	

Monday, 7th May 2018

Time: 10:00 h to 10:30 h

Opening Session
Auditorium

Opening Addresses

Chaired by the Portuguese Minister of the Sea,
Ana Paula Vitorino

Time: 10:30 h – 12:30 h

Plenary Session
Auditorium

Co-Chairs: C. Guedes Soares & P. Ponte

Developments and Challenges of the Maritime
Economy
Miguel Marques (PWC)

West SEA - Building a New Path
Filipe Rosa (West SEA)

Subsea Production Systems for Deepwater Application
Segen F. Estefen (UFRJ)

Time: 14:00 h to 15:30 h

Dynamics & Control
Room 01.1

Co-Chairs: M. Mendes; S. Sutulo

*Assessment of the electric propulsion motor controller
for the Colombian Offshore Patrol Vessel*
*C. Morales, E. Insignares, B. Verma, D. Fuentes & M.
Ruiz*

*Simulation of a marine dynamic positioning system
equipped with cycloidal propellers*
M. Altosole, S. Donnarumma, V. Spagnolo & S. Vignolo

Reliability analysis of Dynamic Positioning Systems
M.V. Clavijo, M.R. Martins & A.M. Schlede

Ship Design
Room 02.3

Co-Chairs: P. Georgiev; M. F. Ventura

Critical wind velocity for harbor container stability
A. Balbi, M.P. Repetto, G. Solari & A. Freda

*Tool for initial hull structure dimensioning at ship concept
design*
F. Sisci & M. Ventura

*Conceptual design of multipurpose ship and fleet
accounting for SME shipyard building limitations*
T. Damyranliev, P. Georgiev, I. Atanasova & Y. Garbatov

Time: 16:00 h – 17:30 h

Ship Performance
Room 01.1

Co-Chairs: J.-M. Laurens; R. Vettor

*Design related speed loss and fuel consumption of ships
in seaways*
M. Riesner, O. el Moctar & T.E. Schellin

*Influence of main engine control strategies on fuel
consumption and emissions*
R. Vettor, M. Tadros, M. Ventura & C. Guedes Soares

*Analysis of multipurpose ship performance accounting
for SME shipyard building limitations*
Y. Denev, P. Georgiev & Y. Garbatov

Structures in Composite Materials
Room 02.3

Co-Chairs: R. Centeno; L. S. Sutherland

*Experimental and numerical structural analysis of a
windsurf fin*
F. Nascimento, L.S. Sutherland & Y. Garbatov

*Uncertainty propagation and sensitivity analysis of a
laminated composite beam*
M. Calvário, A. P. Teixeira & C. Guedes Soares

*Experimental study of the residual strength of damaged
hybrid steel - FRP balcony overhangs of ships*
N. Kharghani & C. Guedes Soares

Tuesday, 8th May 2018

Time: 9:00 h to 10:30 h

Ports Performance I

Room 01.1

Co-Chairs: R. C. Botter; T. A. Santos

Comparative analysis of port performances between Italy and Brazil

A. N. Nascimento, A. M. Wahrhaftig & H. J. C. Ribeiro

Evaluation of port performance: research opportunities from the systemic analysis of international literature

G. C. Fermino, A. Dutra, L. Ensslin & S. R. Ensslin

Performance evaluation of the infrastructure of Ports from Santa Catarina State

J.P. Meirelles, S. R. Ensslin, E.M. Luz, A. Dutra & L. Ensslin

Ship Motions I

Room 02.1

Co-Chairs: S. Sutulo; I. Catipovic

Characterization of ship motions induced by wake waves

F.G.L. Pedro, J. A. Santos, L. V. Pinheiro C. J. E. M. Fortes & M. Hinostroza

Motions and mooring loads of a tanker moored at open jetty in long crested irregular waves including second order effects

H.S. Abdelwahab & C. Guedes Soares

Numerical and experimental study of ship-generated waves

S.R.A. Rodrigues, C. Guedes Soares & J. A. Santos

Wave-structure interaction

Room 02.3

Co-Chairs: S. Wang; S. Mohapatra

Comparisons of CFD, experimental and analytical simulations of a heaving box-type floating structure

H. Islam, S. C. Mohapatra & C. Guedes Soares

TLP surge motion: A nonlinear dynamic analysis

S. Amat & M.J. Legaz

Wave interaction with a rectangular long floating structure over flat bottom

Y. Guo, S. C. Mohapatra & C. Guedes Soares

Time: 11:00 h to 12:30 h

Ports Performance II

Room 01.1

Co-Chairs: J. C. Quaresma Dias; P. Ponte

Improving capacity of port shunting yard

A. Rusca, F. Rusca, E. Rosca, V. Dragu & M. Rosca

Analysis of a new container terminal using a simulation approach

N. A. S. Mathias, T. A. Santos & C. Guedes Soares

Operational and cost based analysis of ship to ship – transshipment – in Brazil. An application to the iron ore in the port of Santos

P.C.M. Oliveira & R.C. Botter

Ship Motions II

Room 02.1

Co-Chairs: J. A. Santos; R. Vettor

Hydrodynamic study of the influence of bow and stern appendages in the performance of the vessel OPV 93

B. Verma, D. Fuentes, L. Leal & F. Zarate

Seakeeping optimization of a catamaran to operate as fast crew supplier at the Alentejo basin

F. Belga, M. Ventura & C. Guedes Soares

Comparative study of various strip-theory seakeeping codes in predicting heave and pitch motions of fast displacement ships in head seas

F. Belga, S. Sutulo & C. Guedes Soares

Wave and Wind Energy

Room 02.3

Co-Chairs: J. W. Ringsberg; T. Iseki

Experimental study on auto-parametrically excited heaving motion of a spar-buoy

T. Iseki

Optimization of Wave Energy Converters in the OPWEC Project

F. Taveira-Pinto, P. Rosa-Santos, C. A. Rodríguez, M. López, V. Ramos, S. Xu, K. Rezanejad, S. Wang & C. Guedes Soares

Experimental study of two mooring systems for wave energy converters

S. Xu, S. Wang, T.S. Hallak, K. Rezanejad, M.A. Hinostroza, C. Guedes Soares, C.A. Rodriguez, P. Rosa-Santos & F. Taveira-Pinto

Time: 14:00 h to 15:30 h

Ship Structures I

Room 01.1

Co-Chairs: Y. Garbatov; X. Jiang

Analysis of the ultimate strength of corroded ships involved in collision accidents and subjected to biaxial bending

J.W. Ringsberg, Z. Li, A. Kuznecovs & E. Johnson

Residual strength assessment of a grounded container ship subjected to asymmetrical bending loads

M. Tekgoz, Y. Garbatov & C. Guedes Soares

Strength assessment of an aged single hull tanker grounded in mud and used as port oil storage

N. Vladimir, I. Senjanovic, N. Alujevi & D.S. Cho

Computational Fluid Dynamics

Room 02.1

Co-Chairs: D. Villa; S. Wang

Wake of a catamaran navigating in restricted waters

G. McSullea, J. M. Rodrigues & C. Guedes Soares

A CFD study of a ship moving with constant drift angle in calm water and waves

H. Islam & C. Guedes Soares

Ship self-propulsion performance prediction by using OpenFOAM and different simplified propeller models

S. Gaggero, T. Gaggero, G. Tani, G. Vernengo, M. Viviani & D. Villa

Risk Analysis

Room 02.3

Co-Chairs: Â.P. Teixeira; S. F. Estefen

Risk analysis of ships & offshore wind turbines collision: Risk evaluation and case study

A. Qing Yu, B. Kezhong Liu, C. Jinfen Zhang & D. Xuri Xin

Risk analysis of innovative maritime transport solutions using the extended Failure Mode and Effects Analysis (FMEA) methodology

E. Chalkia, E. Sdoukopoulos & E. Bekiaris

Sensitivity analysis of risk-based conceptual ship design

F. Sisci & Y. Garbatov

Time: 16:00 h to 17:30 h

Ship Structures II

Room 01.1

Co-Chairs: J. W. Ringsberg; J. M. Gordo

Failure assessment of transition piece of jacket offshore wind turbine

B. Yeter, Y. Garbatov & C. Guedes Soares

Low-cycle fatigue of damaged stiffened panel in ship structures

I. Gledi & J. Parunov

Failure assessment of wash plates with different degree of openings

S. Saad-Eldeen, Y. Garbatov & C. Guedes Soares.

Ship Resistance

Room 02.1

Co-Chairs: D. Villa; J. M. Varela

Experimental Study of Frictional Drag Reduction on a Hull Model by Air-Bubbling

E. Ravina & S. Guidomei

Procedure for production of scaled ship models for towing tank testing

K. D. Giannisi, D.E. Liarokapis, J. P. Trachanas, G. P. Milonas & G. D. Tzabiras

A benchmark test of ship resistance in extremely shallow water

Q. Zeng, C. Thill & R. Hekkenberg

Offshore and Subsea Technology

Room 02.3

Co-Chairs: S. F. Estefen; Â.P. Teixeira

Risk assessment of subsea oil and gas production systems at the concept selection phase

M. Abdelmalek & C. Guedes Soares

Availability assessment of a power plant working on Allam cycle

U. Bhardwaj, A. P. Teixeira & C. Guedes Soares

Subsea water separation: a promising strategy for offshore field development

Y.X. Wang, C. Hong, J.K. Yang, S.F. Estefen & M.I. Lourenço

Wednesday, 9th May 2018

Time: 9:00 h to 10:00 h

Coating & Corrosion

Room 01.1

Co-Chairs: Y. Garbatov; J. W. Ringsberg

Internal corrosion simulation of long distance sandwich pipe

Cheng Hong, Yuxi Wang, Jiankun Yang, S. F. Estefen & M. I. Lourenço

Ceramic coating solution for offshore structures

S. Garcia, A. Trueba, L. M. Vega & E. Madariaga

Maintenance

Room 02.1

Co-Chairs: J. Sobral; P. Viana

Life cycle and cost performance analysis on ship structural maintenance strategy of a short route hybrid
H. Wang, E. Oguz, B. Jeong & P. Zhou

An integrated operational system to reduce O&M cost of offshore wind farms

Kai Wang, Xiaoli Jiang, Xiping Yan, Yupeng Yuan & Rudy R. Negenborn

Ships on condition data driven maintenance management

S. Lampreia, V. Lobo, V. Vairinhos & J. G. Requeijo

Ships in Transit

Room 02.3

Co-Chairs: S. Sutulo; J. A. Santos

The transit state evaluation of a large floating dock by seakeeping criteria

E. Burlacu & L. Domnisoru

Comparison of dynamics and quasi-static towline model for evaluation of wave-induced towed ship motions

I. Catipovic

Time: 10:30 h to 12:30 h

Maritime Transportation and Economics

Room 01.1

Co-Chairs: R. Salvador; J. C. Quaresma Dias

Motorways of the sea

J.-M. Laurens & P.-M. Guilcher

Characterizing the operation of a roll-on roll-off short sea service

T. A. Santos, C. Guedes Soares & R. C. Botter

Evaluation of the Portuguese ocean economy using the satellite account for the sea

A. Simões, R. Salvador & C. Guedes Soares

Port of Santos – Brazil: Essential factors to implement a green port system

D.A. Moura & R.C. Botter

Shipyard Technology

Room 02.1

Co-Chairs: J. M. Gordo; F. Gomes Lopes

Model to forecast times and costs of cutting, assembling and welding stages of construction of ship blocks

A. Oliveira & J.M. Gordo

Shipyards of the 21st century. Industrial internet of things on site

V. Diaz Casas, A. Munin Doce, P. Trueba Martinez, S. Ferreño Gonzalez & M. Vilar

Causal analysis of accidents at work in a shipyard complemented with Bayesian Nets modelling

B. Costa, C. Jacinto, A.P. Teixeira & C. Guedes Soares

Analysis of SME shiprepair yard capacity in building new ships
I. Atanasova, T. Damyanliev, P. Georgiev & Y. Garbatov

Waves

Room 02.3

Co-Chairs: C. J. Fortes; M. Bernardino

Numerical analysis of waves attenuation by vegetation in enclosed waters

G. de Oliveira Mattosinho, G. de Freitas Maciel, A. Silveira Vieira & C. Juana Fortes

Peak period statistics associated with significant wave heights by conditional mean functions of the distributions
G. Muraleedharan, C. Lucas & C. Guedes Soares

Analysis of extreme storms in the Black Sea
L. Rusu, M. Bernardino & C. Guedes Soares

Robust estimation and representation of climatic wave spectrum

G. Rodriguez, G. Clarindo & C. Guedes Soares

Time: 14:00 h to 15:30 h

Big Data in Shipping

Room 01.1

Co-Chairs: R. C. Botter; Â.P. Teixeira

Fishing activity patterns for Portuguese seiners based on VMS data analysis

A. Campos, P. Lopes, J. Parente, P. Fonseca, N. Antunes & P. Lousã

Characterizing container ship traffic along the Portuguese coast using Big Data

R. C. Botter, T. A. Santos & C. Guedes Soares

Methodology for estimating technical characteristics of container ships from AIS data

T. A. Santos & C. Guedes Soares

Marine Pollution & Sustainability

Room 02.1

Co-Chairs: A. Moutinho; P. Georgiev

Sustainability in fishing vessel design process 1988-2018

F. Veenstra, J.A.A.M Stoop & J.J.Hopman

Ballast water management: and now, what to do?

L. Guerrero, J. Pancorbo & J. A. Arias.

Persistent organic pollutants in Baltic herring in the Gulf of Riga and Gulf of Finland (north-eastern Baltic Sea)

L. Järv, T. Raid, M. Simm, M. Radin, H. Kiviranta & Päivi Ruokojärvi

Time: 16:00 h to 17:30 h

Intelligent Ship Navigation

Room 01.1

Co-Chairs: S. Sutulo; T. A. Santos

Challenges and developments of water transportation safety under intelligent environment

H.B.Tian, B.Wu & X.P.Yan

Collision avoidance, guidance and control system for Autonomous Surface Vehicles in complex navigation conditions

M. Hinostroza & C. Guedes Soares

A framework of network marine meteorological information processing and visualization for ship navigation

Xin Peng, Yuanqiao Wen, Liang Huang, Chunhui Zhou, Changshi Xiao & Fan Zhang

Role assignment and conflict identification for the encounter ships under COLREGs

Y. Zeng, J.F. Zhang, A.P. Teixeira & C. Guedes Soares

Ship Propulsion

Room 02.1

Co-Chairs: J.-M. Laurens; S. R. Silva

Optimization scheme for the selection of the propeller in ship concept design

M. Tadros, M. Ventura & C. Guedes Soares

Marine propulsion shafting: a study of whirling vibrations

S. Busquier, S. Martinez & M.J. Legaz

Marine diesels working cycle monitoring on the base of IMES GmbH pressure sensors data

S. Neumann, R. A. Varbanets & O. I. Kyrylash



TÉCNICO
LISBOA



ORDEM
DOS
ENGENHEIROS

15^{as} Jornadas
Engenharia e Tecnologia Marítima

JETM 2018

PROGRAMA

7 - 9 Maio 2018

Centro de Congressos do IST
LISBOA, PORTUGAL



JETM 2018

PLANEAMENTO DE SESSÕES

Segunda-feira 7 de Maio de 2018 Inscrições / (Hall 01 –8h30)	
Centro de Congressos do IST	
Sessão de Abertura JETM/MARTECH 2018 (10h00-10h30) – Auditório Presidida por S. Ex. a Ministra do Mar, Ana Paula Vitorino	
Sessão Plenária (10h30-12h30) – Auditório Presidentes de Mesa: C. Guedes Soares & P. Ponte	
Almoço Livre (12h30-14h00)	
Sala 02.1 (14h00-15h30) Construção Naval em Materiais Compósitos Presidentes de Mesa: D. Dimas; J. M. Gordo	Sala 02.2 (14h00-15h30) Painel sobre Economia do Mar Energia Offshore Moderador: M. Marques
Coffee-break (15h30-16h00)	
Sala 02.1 (16h00-17h30) Projeto de Navios Presidentes de Mesa: M. F. Ventura; J. M. Varela	Sala 02.2 (16h00-17h30) Painel sobre Economia do Mar Transporte Marítimo Moderador: M. Marques
Terça-feira, 8 de Maio 2018 Inscrições (Hall 01 –8h30)	
Sala 02.2 (09h00 – 10h30) Eficiência Energética e Novos Combustíveis Presidentes de Mesa: A. Oliveira; P. Ponte	
Coffee-break (10h30-11h00)	
Sala 02.2 (11h00-12h30) Segurança Marítima e Tecnologias de Informação e Comunicação Presidentes de Mesa: Á. P. Teixeira; T.A. Santos	
Almoço Livre (12h30-14h00)	
Sala 02.2 (14h00-15h30) Painel sobre Portos – Administração Portuária Moderador: J. C. Quaresma Dias	
Coffee-break (15h30-16h00)	
Sala 02.2 (16h00-17h30) Painel sobre Portos – Operadores Portuários Moderador: J. C. Quaresma Dias	

PLANEAMENTO DE SESSÕES

Quarta-feira 9 de Maio 2018 Inscrições (Hall 01 –8h30)	
Sala 02.2 (9h00 – 10h30) Transporte Marítimo e Logística Presidentes de Mesa: T.A. Santos; P. Ponte	
Coffee-break (10h00-10h30)	
Sala 02.2 (11h00-12h30) Estaleiros Navais Presidentes de Mesa: J. Ventura de Sousa; J. M. Gordo	
Almoço Livre (12h30-14h00)	
Sala 02.2 (14h00-15h30) Navios Militares I Presidentes de Mesa: P. Pires Silva; F. Salvado	Sala 02.3 (14h00-15h30) Painel sobre Aquacultura no Mar I Moderador: P. Pousão
Coffee-break (15h30-16h00)	
Sala 02.2 (16h00-17h30) Navios Militares II Presidentes de Mesa: F. Salvado; P. Pires Silva	Sala 02.3 (16h00-17h30) Painel sobre Aquacultura no Mar II Moderador: C. Andrade

Comissão Consultiva das JETM

António M. de Carvalho Coelho Cândido, Instituto Hidrográfico, Marinha

José Carlos Simão, Direcção-Geral de Recursos Naturais, Segurança e Serviços Marítimos

José Luis Cacho, Administração dos Portos de Sines e Algarve

José Ventura de Sousa, Associação das Indústrias Navais

Luís Filipe Baptista, Escola Superior Nautica Infante D. Henrique

Luis Miguel Sousa, Grupo Sousa

Manuel Pinto de Magalhães, Portline- Transportes Marítimos

Maria Ana Martins, Instituto Português do Mar e da Atmosfera

Miguel Marques, PricewaterhouseCoopers Portugal

Segunda-feira – 7 de Maio de 2018

10:00 h - 10:30 h

Sessão de Abertura
Auditório*Boas vindas*Presidida por S. Ex. a Ministra do Mar,
Ana Paula Vitorino

10:30 h – 12:30 h

Sessão Plenária
Auditório

Presidentes de Mesa: C. Guedes Soares & P. Ponte

Developments and Challenges of the Maritime Economy
*Miguel Marques (PWC)*West SEA - Building a New Path
*Filipe Rosa (West SEA)*Subsea Production Systems for Deepwater Application
Segen F. Estefen (UFRJ)

14:00 h to 15:30 h

Construção Naval em Materiais Compósitos
Sala 02.1

Presidentes de Mesa: D. Dimas; J.M. Gordo

Estaleiro de construção naval em materiais compósitos
*Rui Roque (Nautiber)*Construção de embarcações de recreio pelo método de
infusão
*Francisco Caldeira (Levant)*Painel sobre Economia do Mar
Energia Offshore
Sala 02.2

Moderador: M. Marques

Painel de debate com a participação dos oradores:

- *João Cardoso, Especialista em Energia Offshore*
- *Pedro Ponte, Ordem dos Engenheiros*
- *João Oliveira, A. Silva Matos*
- *EDP Renováveis (a confirmar)*

16:00 h – 17:30 h

Projeto de Navios
Sala 02.1

Presidentes de Mesa: M. F. Ventura; J. M. Varela

Projecto e construção de catamarans em alumínio para
actividade marítimo-turística
*José Cruz (OCEAN)*Construção de embarcação em compósitos
*Frederico Oliveira Fernandes (ENP)*Painel sobre Economia do Mar
Transporte Marítimo
Sala 02.2

Moderador: M. Marques

Painel de debate com a participação dos oradores:

- *Andreia Ventura - Terminal de Contentores do Beato*
- *Fernando Grego Dias - Mutualista Açoreana*
- *Filipe Rosa - West SEA Shipyard*
- *Gonçalo Delgado - ETE*
- *José Ventura de Sousa - Associação das Indústrias Navais*
- *Sociedade de Desenvolvimento da Madeira*

Terça-feira – 8 de Maio de 2018

9:00 h - 10:30 h

Eficiência Energética e Novos Combustíveis
Sala 02.2

Presidentes de Mesa: A. Oliveira; P. Ponte

A eficiência energética nos estaleiros navais
Marco Marques (Lisnave)

Shore power connections
Matthieu Marquet (Schneider Electric)

Energy efficiency solutions
Matthieu Marquet (Schneider Electric)

Ship repair efficiency - an inside view by Shipowner
Rui Morgado (Mutualista)

A eficiência energética e novos combustíveis nos novos navios da Transtejo
António Ferreira (Transtejo)

11:00 h - 12:30 h

Segurança Marítima e Tecnologias de
Informação e Comunicação
Sala 02.2

Presidentes de Mesa: Â.P. Teixeira; T.A. Santos

Salvamento marítimo e socorro a náufragos em Portugal: o papel do ISN
Velho Gouveia (ISN)

O sistema de busca e salvamento em alto mar da Marinha Portuguesa
Bento Domingues (Marinha)

Análise de acidentes marítimos em Portugal
Miguel Sequeira (GAMA)

Latest developments in Safeseanet and the Integrated Maritime Services application
Marta Lima Galvão (EMSA)

14:00 h - 15:30 h

Painel sobre Portos
Administração Portuária
Sala 02.2

Moderador: J. C. Quaresma Dias

Painel de debate com a participação dos Presidentes de:

- *Administração do Porto de Leixões (Guilhermina Rego)*
- *Administração do Porto de Lisboa (Lídia Sequeira)*
- *Administração dos Portos de Setúbal e Sesimbra (Lídia Sequeira)*
- *Administração dos Portos de Sines e Algarve (José Luís Cacho)*

16:00 h - 17:30 h

Painel sobre Portos
Operadores Portuários
Sala 02.2

Moderador: J.C.Quaresma Dias

Painel de debate com a participação das empresas:

- *MSC (Carlos Vasconcelos)*
- *Yilport Leixões (Nuno David Silva)*
- *Comunidade Portuária de Setúbal (Porfírio Gomes)*
- *PTM Ibérica (Nelson Santos)*

Quarta-feira – 9 de Maio de 2018

9:00 h - 10:30 h

Transporte Marítimo e Logística
Sala 02.2

Presidentes de Mesa: T. A. Santos; P. Ponte

Gás natural para a Madeira: caso de estudo
Pedro Frazão (Grupo Sousa)

Panorâmica e desafios do sector shortsea em Portugal
Eduardo Bandeira (Shortsea Portugal)

O projecto de transporte fluvial de contentores
Henrique Pestana (Grupo ETE)

Janela Única Logística
José Simão (DGRM)

11:00 h - 12:30 h

Estaleiros Navais
Sala 02.2

Presidente de Mesa: J. Ventura de Sousa

Panorama e perspectivas da indústria naval em Portugal
José Ventura de Sousa (AIN)

Desafios da construção do Empurrador “Baía do Seixal”
Miguel Trovão (Navaltagus)

Programa de capacitação do Arsenal do Alfeite para a
Manutenção Planeada de Submarinos
Luis Ribeiro da Silva (Arsenal do Alfeite)

Construção do Windfloat
Aguiar Ferreira (ASM Industries)

14:00 h - 15:30 h

Painel sobre Aquacultura no Mar I
Sala 02.3

Moderador: Pedro Pousão

Intervenientes:

Sines e outros projetos de jaulas a Norte
Pedro Encarnação, Grupo Jerónimo Martins

Long-lines de mexilhão em Lagos
Miguel Cunha, Testa e Cunhas

Long-lines de mexilhão em Sagres
Lourenço Ribeiro, Finisterra

Armação de atuns em Olhão
Carlos Reis/Morikawa, Tunipex

Long-lines de ostras em Sagres
Jean Jacques Guignard, AquaSacrum

Navios Militares I

Sala 02.2

Presidentes de Mesa: P. Pires Silva; F. Salvado

O processo de aquisição dos NPO
Lopes Moreira e Moreira Guerreiro (Marinha)

A integração e operação dos NPO: uma perspetiva
operacional
Guardado Neto (Marinha)

O processo de aquisição dos Navios Patrulha Costeiros
da Classe Tejo
Santos Fonseca (Marinha)

A integração e operação dos Navios Patrulha Costeiros
Classe Tejo: uma perspetiva operacional.
Pedro Vacas de Carvalho (Marinha)

16:00 h - 17:30 h

Painel sobre Aquacultura no Mar II
Sala 02.3

Moderador: Carlos Andrade

Temas a abordar:

- Localização das pisciculturas e contexto regulamentar
- Sistema de jaulas e amarrações em uso - projecto, engenharia e operação
- A gestão geral e a logística das pisciculturas
- Que futuro para a piscicultura em mar aberto?

Intervenientes:

Élvio Pontes, Aquabaía

Pedro Diniz, Marismar

Pedro Encarnação, Grupo Jerónimo Martins

Tiago Aires, Sorgal

Navios Militares II

Sala 02.2

Presidentes de Mesa: F. Salvado; P. Pires Silva

Os desafios da construção de navios militares para os
estaleiros WestSea
Francisco Salvado (WestSea)

A plataforma de controle e comunicações dos NPO
Rui Cohen (Edisoft-Thales Portugal)

A Experiência do Arsenal do Alfeite na execução da
Manutenção Planeada dos NPO Viana do Castelo
A. Rodrigues Mateus (Arsenal do Alfeite)

Os desafios da classificação/certificação de navios
militares
Paulo Viana (DNVGL)

CONFERENCE VENUE

MARTECH2018 and JETM 2018 will be held at the Instituto Superior Técnico's Congress Centre at the Alameda Campus. The MAP below shows the location of the IST's Congress Centre in the Campus, and the location of the Hotel Holiday Inn Lisboa where lunches will be served for the MARTECH registered participants.



MARTECH2018 and JETM2018 will take place at **IST's Congress Centre** ★ located on the Lower Ground 1 and Lower Ground 2 Levels, and will be concentrated in the Auditorium (Monday morning) and 4 meeting rooms for the parallel sessions.

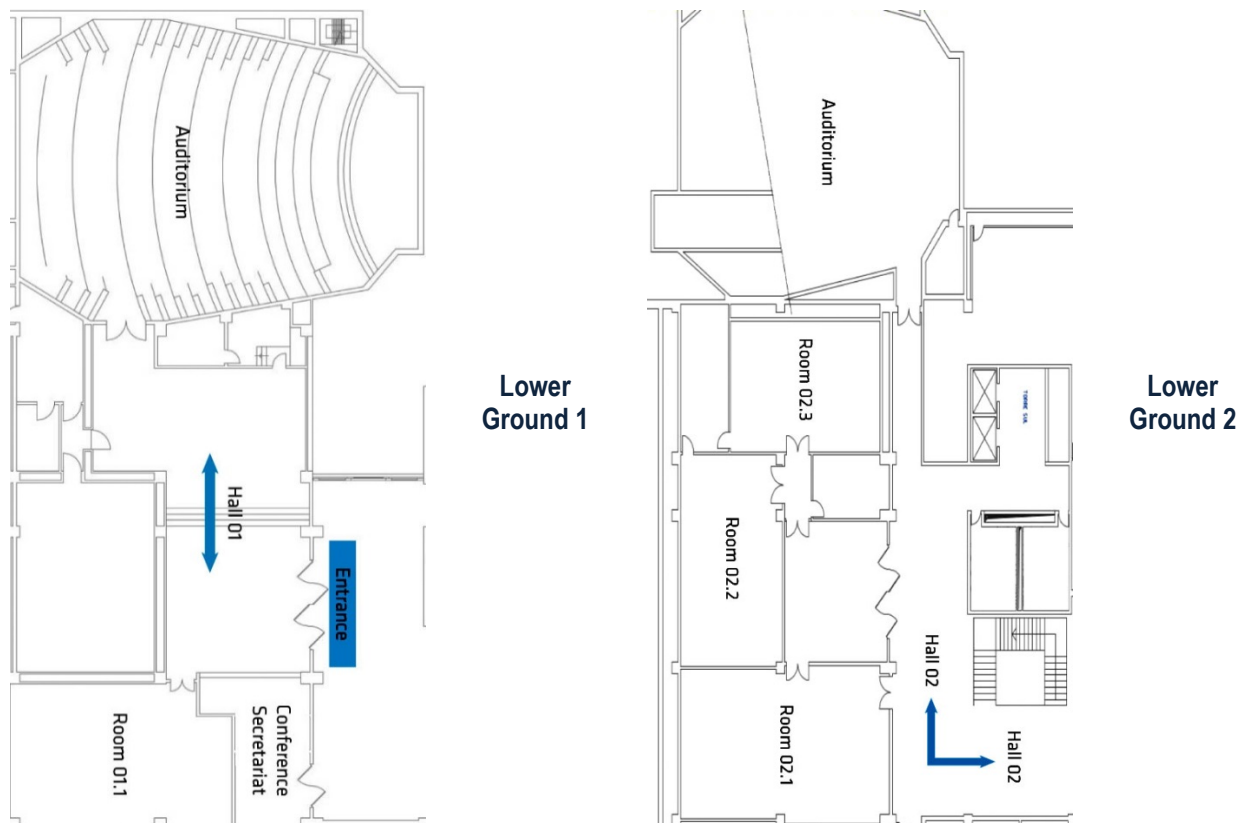



IMPORTANT CONTACTS

Congress Location	CENTEC	Congress Dinner
IST Congress Centre Instituto Superior Técnico Universidade de Lisboa Avenida Rovisco Pais, Lisboa 1049-001 Tel: +351 218 418 069	Centre for Marine Technology and Ocean Engineering (CENTEC) Instituto Superior Técnico Avenida Rovisco Pais Lisboa 1049-001 Tel: +351 218 417 468	Restaurante Ordem dos Engenheiros Avenida António Augusto de Aguiar, N.º 3-D, 6º piso 1069-030 - Lisboa Tel: 213 156 456
WIFI Access: 📶 Network: Técnico-Guest 📶 Username: martech 📶 Password: VzNDSw		Emergency Number: 112

SPONSORS | PATROCINADORES



galp
energia



YILPORT
IBERIA



Grupo Álava

